

Frese frontali, serie lunga

Schaftfräser lange Ausführung

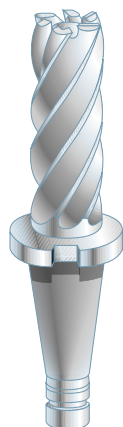
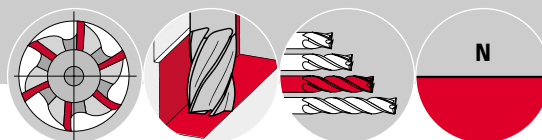

**Tipo N, ≈ 30° elica,
10° angolo di spoglia,
con codolo conico ISO
secondo DIN 2080**

End mills, long series
Type HRS, helix angle ≈ 30° rake angle 10°,
with step ISO taper shank acc. DIN 2080

**Typ N, ≈ 30° Drallwinkel,
10° Spanwinkel,
mit Steikegelschaft nach
DIN 2080**

Fraises deux tailles, série longue
Type N, angle d'hélice ≈ 30°, angle de
coupe 10°, avec queue cône SA DIN 2080

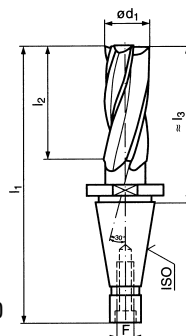

**DIN 2328L
HSS-Co5**

HSS-Co5

Cat. Nr. - Kat. Nr. - Cat. no. - No. de cat.							9502
Ød1 K ₁₀	l ₂	l ₁	ISO	F	l ₃	Z	
32	106	241	40	M 16	148	6	●
36	106	241	40	M 16	148	6	■
40	125	260	40	M 16	167	6	●
40 [▲]	100	277	50	M 24	150	6	■
40	125	302	50	M 24	175	6	●
40 [▲]	160	337	50	M 24	210	6	●
45	125	260	40	M 16	167	8	■
45 [▲]	100	277	50	M 24	150	8	■
45	125	302	50	M 24	175	8	■
45 [▲]	160	337	50	M 24	210	8	■
50	150	285	40	M 16	192	8	●
50 [▲]	112	289	50	M 24	162	8	■
50	150	327	50	M 24	200	8	●
50 [▲]	200	377	50	M 24	250	8	●
56	150	285	40	M 16	192	8	■
56 [▲]	112	289	50	M 24	162	8	■
56	150	327	50	M 24	200	8	■
56 [▲]	200	377	50	M 24	250	8	■
63 [▲]	140	317	50	M 24	190	8	■
63	180	357	50	M 24	230	8	●
63 [▲]	250	427	50	M 24	300	10	●
75 [▲]	110	287	50	M 24	160	10	■
75 [▲]	150	327	50	M 24	200	10	■
75 [▲]	300	411	50	M 24	350	10	●
80 [▲]	160	337	50	M 24	210	10	■
80	212	389	50	M 24	262	10	■
80 [▲]	250	427	50	M 24	300	10	■
80 [▲]	300	477	50	M 24	350	10	■

● Utensile disponibile a magazzino - Tool in stock - Werkzeug vorrätig ab lager - Outil disponible à stock
 ■ Fino ad esaurimento scorte - Solange der Vorrat reicht - Discontinued available until sold out - Jusqu'à épuisement de stock
 ▲ ILLICO NORM